

USINAGE
MARCOTTE

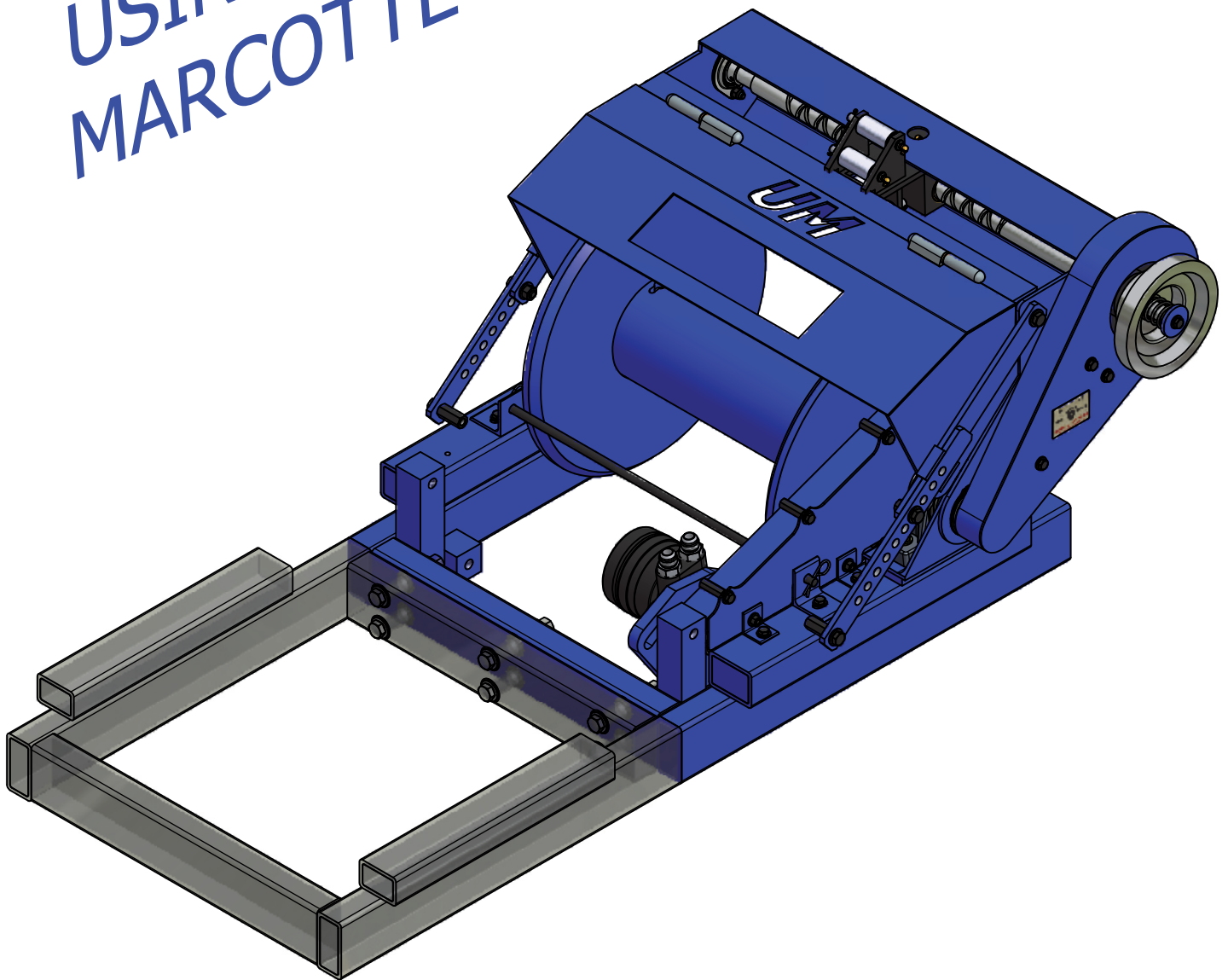

USINAGE
MARCOTTE Inc.



180 Des distributeurs
Val-d'Or, Québec
Canada J9P-6Y1
Tel : (819) 824-3977
Fax : (819) 824-1077
Email : info@umvd.ca
Web : www.umvd.ca

HOIST WIRE LINE
10 000' / 3048 Metre

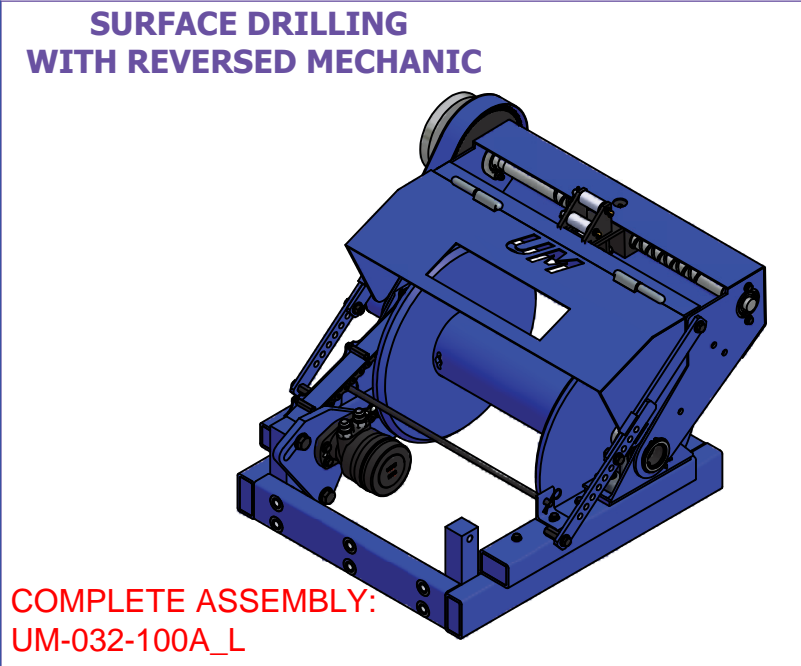
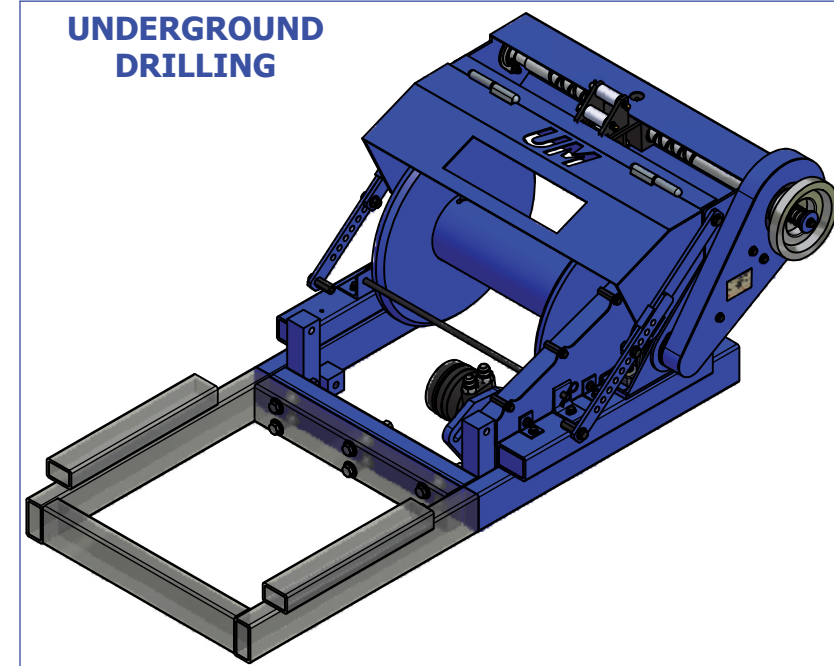
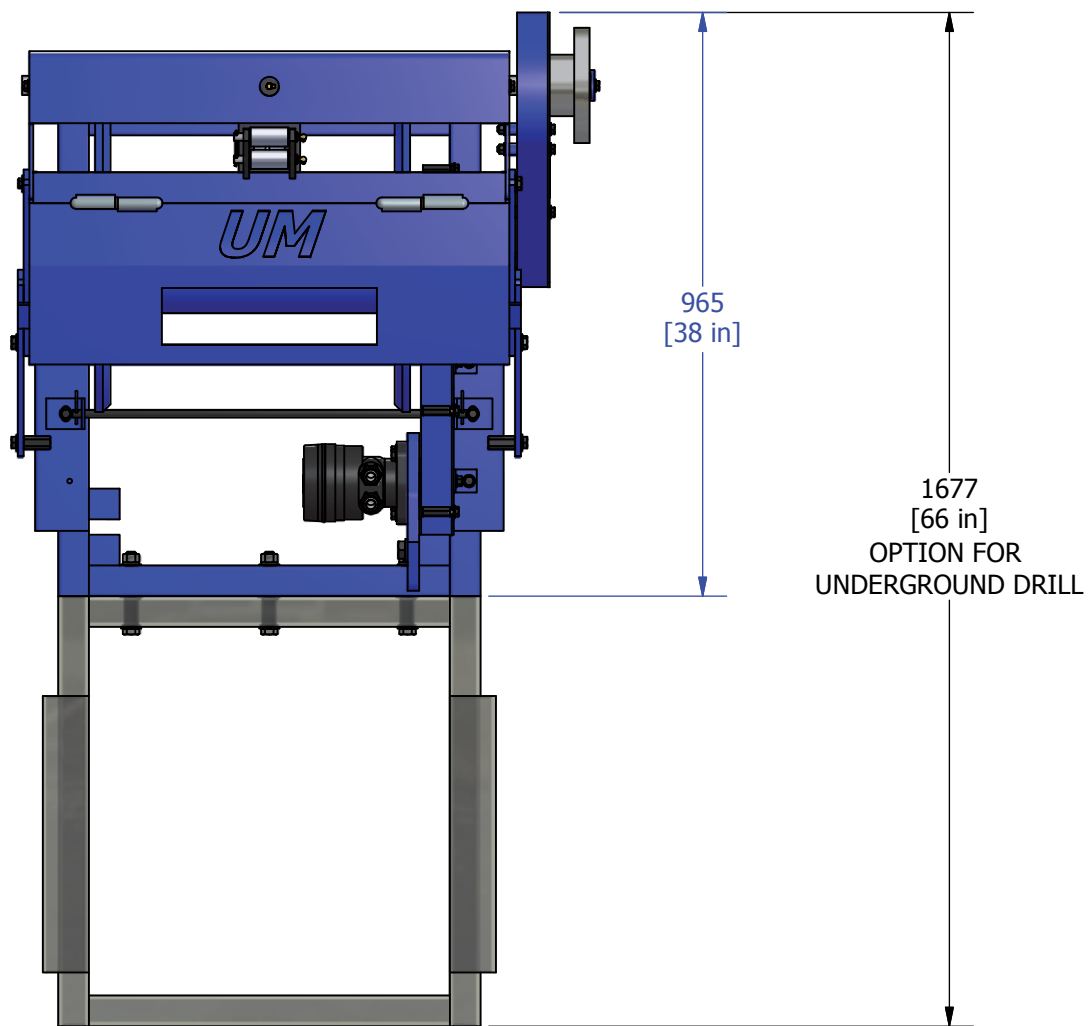

COMPLETE ASSEMBLY:
UM-032-100A_L

HOIST WIRE LINE OVERALL
DIMENSION (10 000' / 3048 Metre)

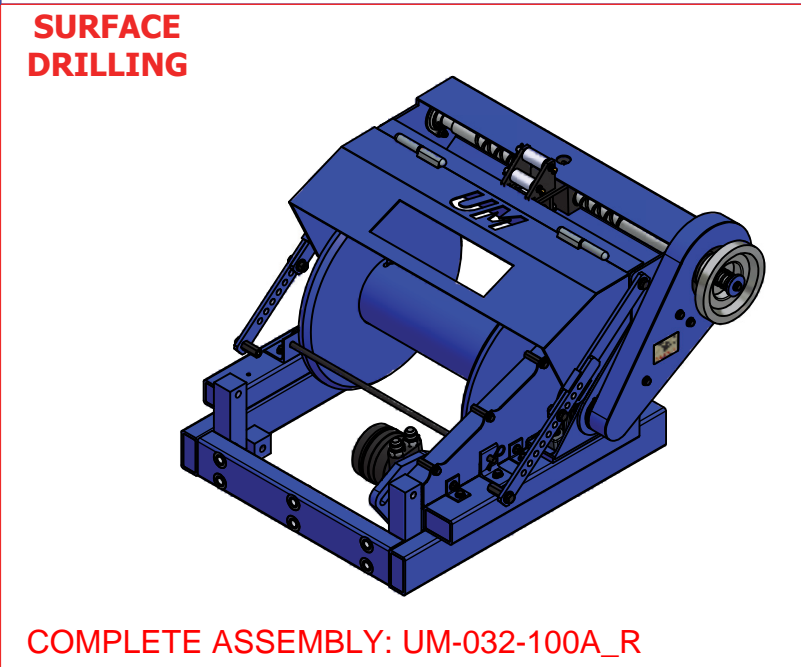

COMPLETE ASSEMBLY: UM-032-100A_R

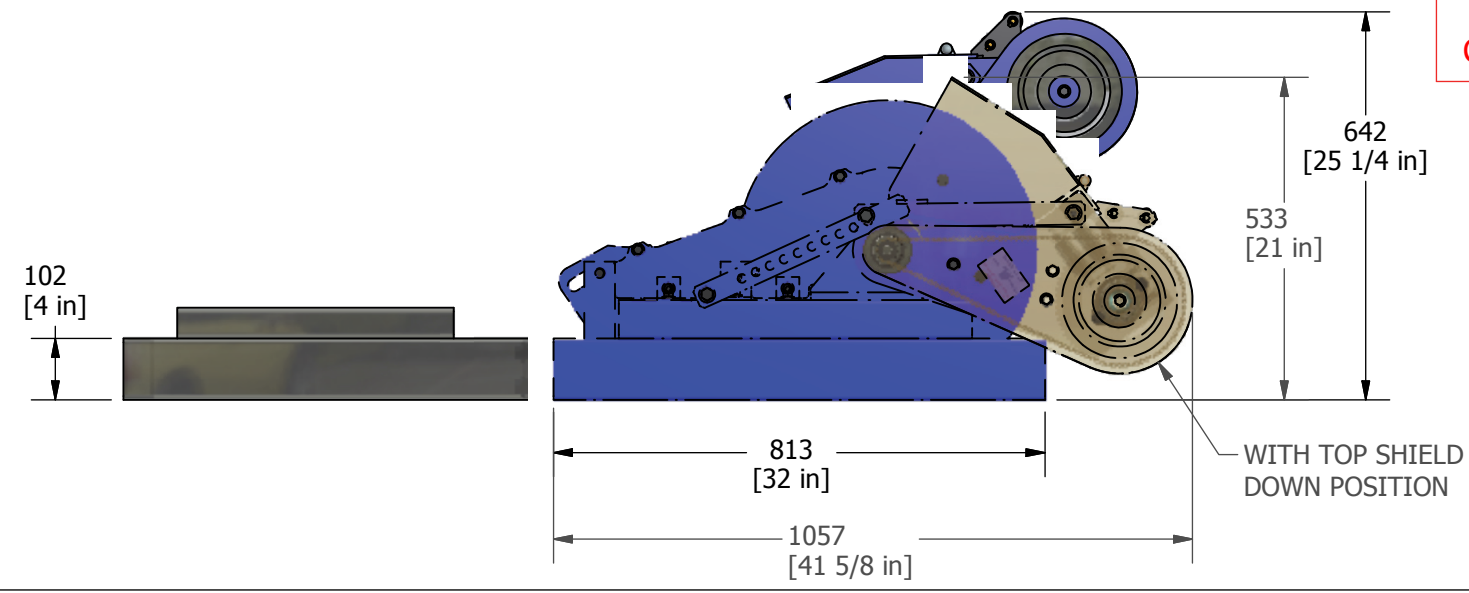
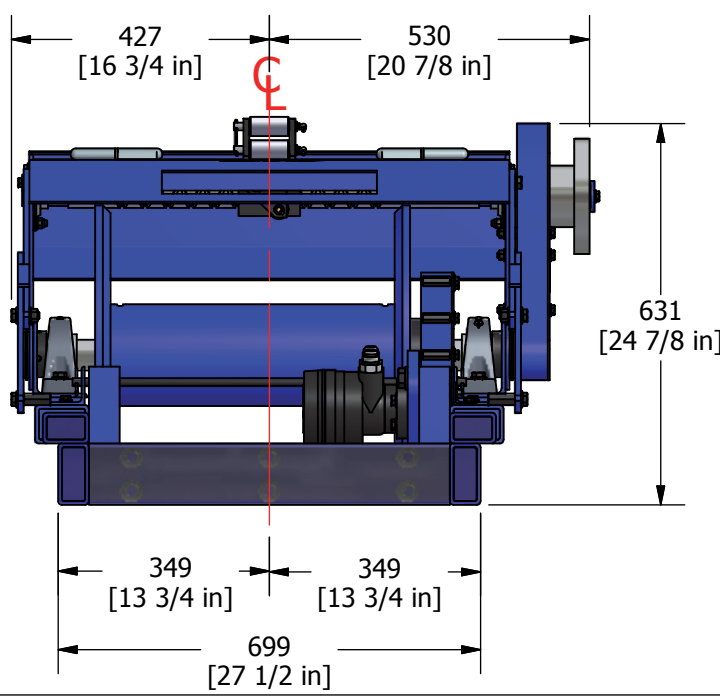

DESIGNED BY:	CHECK BY:
# DRAFT: UM-032-C-8.0-REV3	DRAFT BY: G.Laroche
# PROJECT: UM-032	REV. 0
SCALE: N.T.S.	DATE:
TITLE	

HOIST WIRE LINE OVERALL DIMENSION (10 000' / 3048 Metre)



LISTE DE PIÈCE

OLD NUMBER	ITEM	NOM/NAME	QTE
	B375-1250	BOLT 3/8 - 16 NC X 1 1/4	10
	B375-3500	BOLT 3/8-UNC x 3 1/2"	6
101F	SP250-1250	SPRING PIN 1/2" x 1 1/4"	4
168F	SP375-3000	SPRING PIN 3/8" x 3"	2
	UM-032-102F	SPRING HANDWHEEL	2
	UM-032-103A	CHAINE GUARD (STRINGER CABLE)	2
	UM-032-163F	SPECIAL WASHER	2
	UM-032-169F	HANDWHEEL	2
	W375	FLAT WASHER 3/8	25

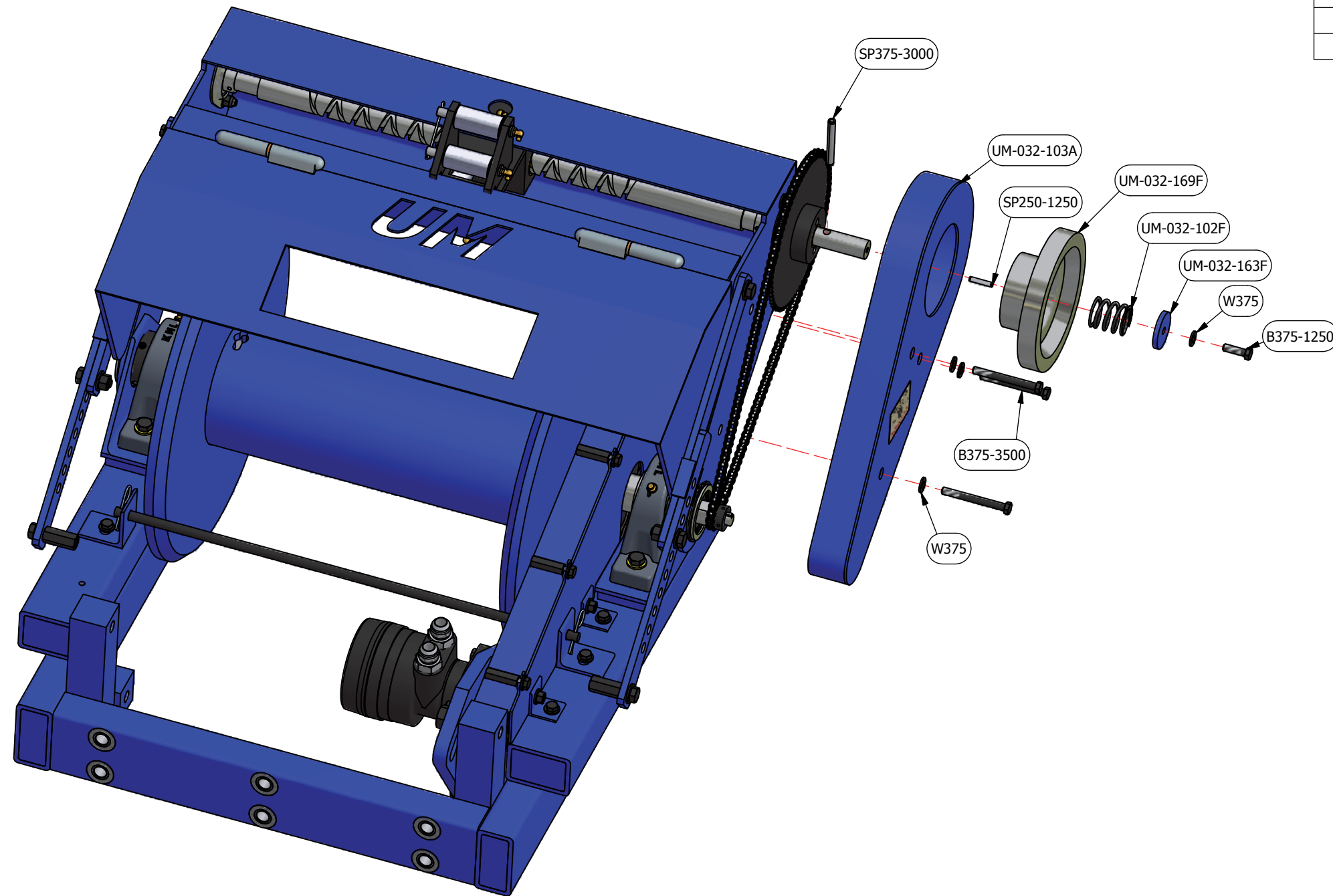

DESIGNED BY:	CHECK BY:
# DRAFT: UM-032-C-8.1_REV3	DRAFT BY: G.Laroche
# PROJECT: UM-032	SCALE: N.T.S.
REV. 0	DATE:
TITLE	
STEP 1	



LISTE DE PIÈCE		
ITEM	NOM/NAME	QTE
SPN-R3000-X237	INT. RET. RING SERIWE 3000 (2 3/8 x 0.78)	1
UM-032-109F	SPROCKET LEADING 35B11	2
UM-032-110F	SPROCKET LEAD 35B70	2
UM-032-162F	SPROCKET ADAPTOR 35	2
UM-032-165F	BUSHING BRASS	2
UM-032-224F	KEY 3/16 x 3/4 X 3/4 Lg	2
UM-032-236F	DRUM GUIDE	1
UM-032-C1	CHAINE 35 (46 1/2 Lg)	2

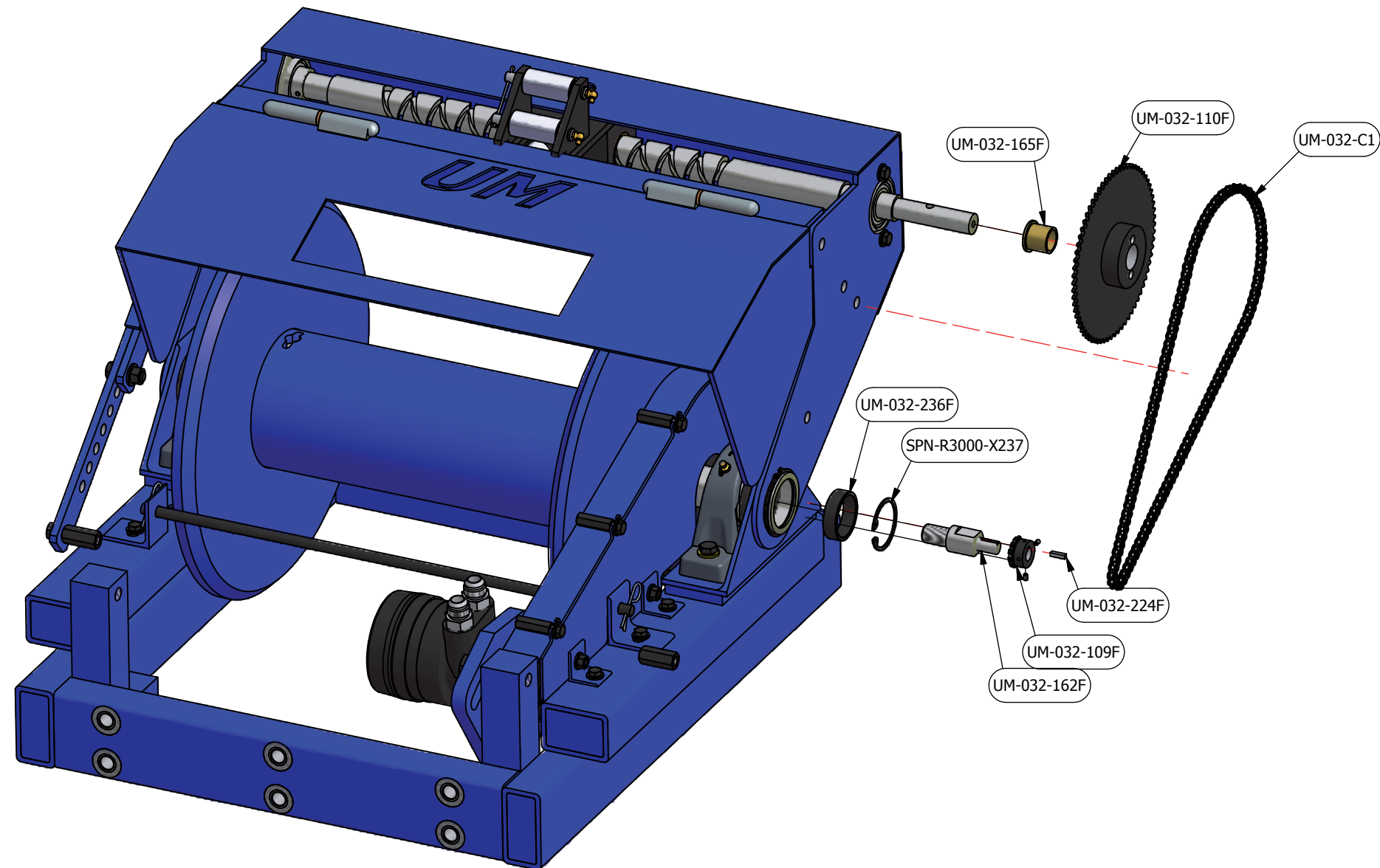

DESIGNED BY:	CHECK BY:
# DRAFT: UM-032-C-8.2-REV3	DRAFT BY: G.Laroche
# PROJECT: UM-032	REV. 3
SCALE: N.T.S.	DATE:
TITLE	
STEP 2	

USINAGE MARCOTTE inc.
180 Des distributeurs
 Val-d'Or, Québec
 Canada J9P-6Y1
 Tél : (819) 824-3977
 Fax : (819) 824-1077
 Email : info@umv.ca
 Web : www.umv.ca

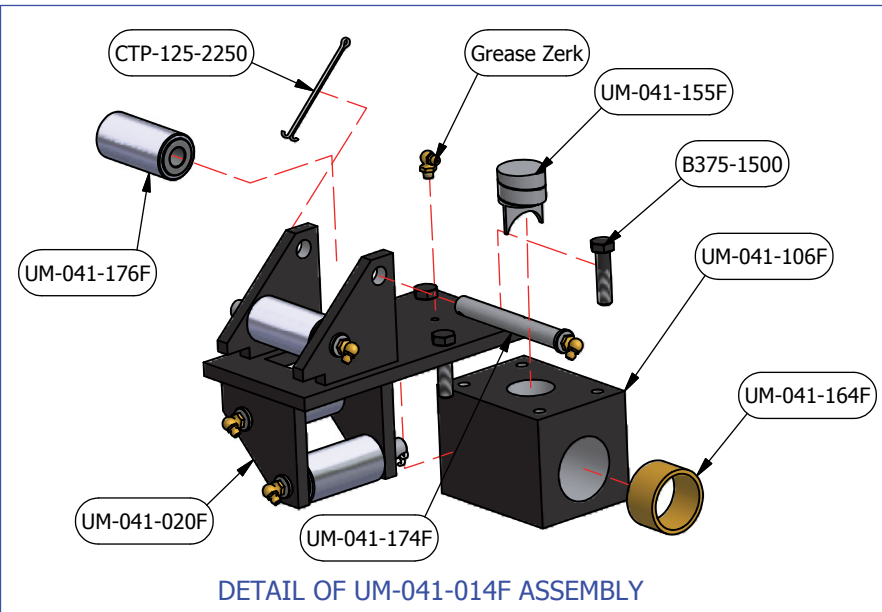

DETAIL OF UM-041-014F ASSEMBLY

LISTE DE PIÈCE

OLD NUMBER	ITEM	NOM/NAME	QTE
	UM-041-164F	BRASS BUSHING 1 3/4"	2
	UM-041-106F	BLOCK BUSHING LEAD SCREW	1
	UM-041-155F	LEAD SCREW PIN	1
	B375-1500	BOLT 3/8 -16 NC X 1 1/2	4
151F	UM-041-020F	ROLLER FRAME ASSEMBLY	1
	Grease Zerk		1
	UM-041-176F	ROLLER CABLE GUIDE	4
	UM-041-174F	ROLLER PIN ASSEMBLY	4
	CTP-125-2250	CUTTER PIN 1/8" X 2 1/4"	2

LISTE DE PIÈCE			
OLD NUMBER	ITEM	NOM/NAME	QTE
143F	UM-032-105A	TOP BACK SHIELD	1
	UM-032-108A	TOP FRONT SHIELD	1
	UM-032-115F	LOWER ARM	2
	UM-032-116F	UPPER ARM	2
	UM-032-226F	10 000' LEAD SCREW	2
151F	UM-041-014F	WIRE GUIDE ASSEMBLY	1
	W375	FLAT WASHER 3/8	8
	W500	FLAT WASHER 1/2"	8

LISTE DE PIÈCE			
OLD NUMBER	ITEM	NOM/NAME	QTE
	B375-1250	BOLT 3/8 - 16 NC X 1 1/4	10
	B500-1500	BOLT 1/2-UNC x 1 1/2	2
	LN375NF	LOCK NUT 3/8"-NF	4
	NC500	NUT 1/2-UNC	2
	PFL206	HOUSING BEARING	4
	SB206-20	INSERT BEARING 1 1/4"	2
	SPN-R3100-300	EXT.RET.RING SÉRIE. (3100)	2

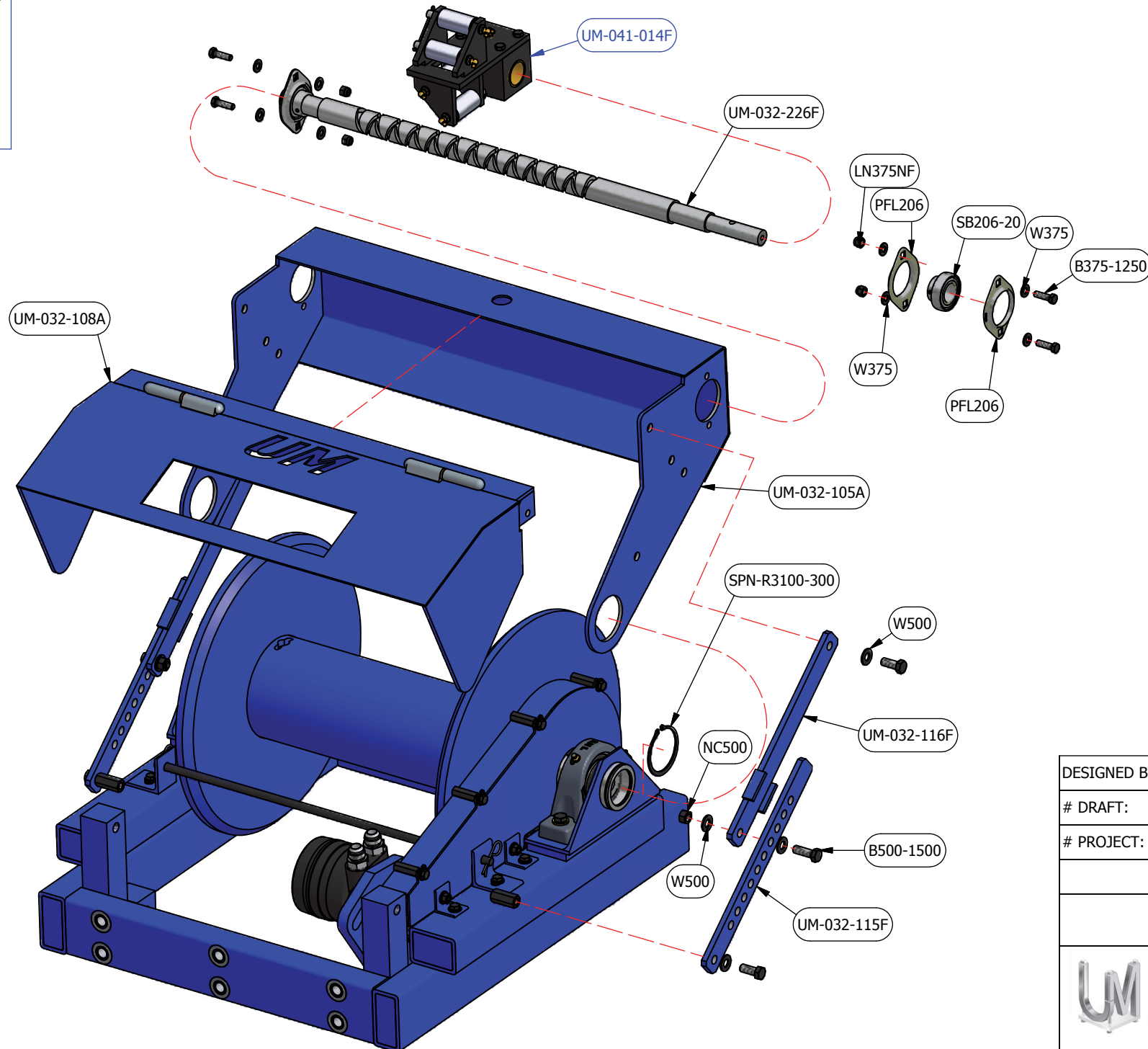

DESIGNED BY:	CHECK BY:
# DRAFT: UM-032-C-8.3-REV3	DRAFT BY: G.Laroche
# PROJECT: UM-032	REV. 3
SCALE: N.T.S.	DATE:
TITLE	
STEP 3	



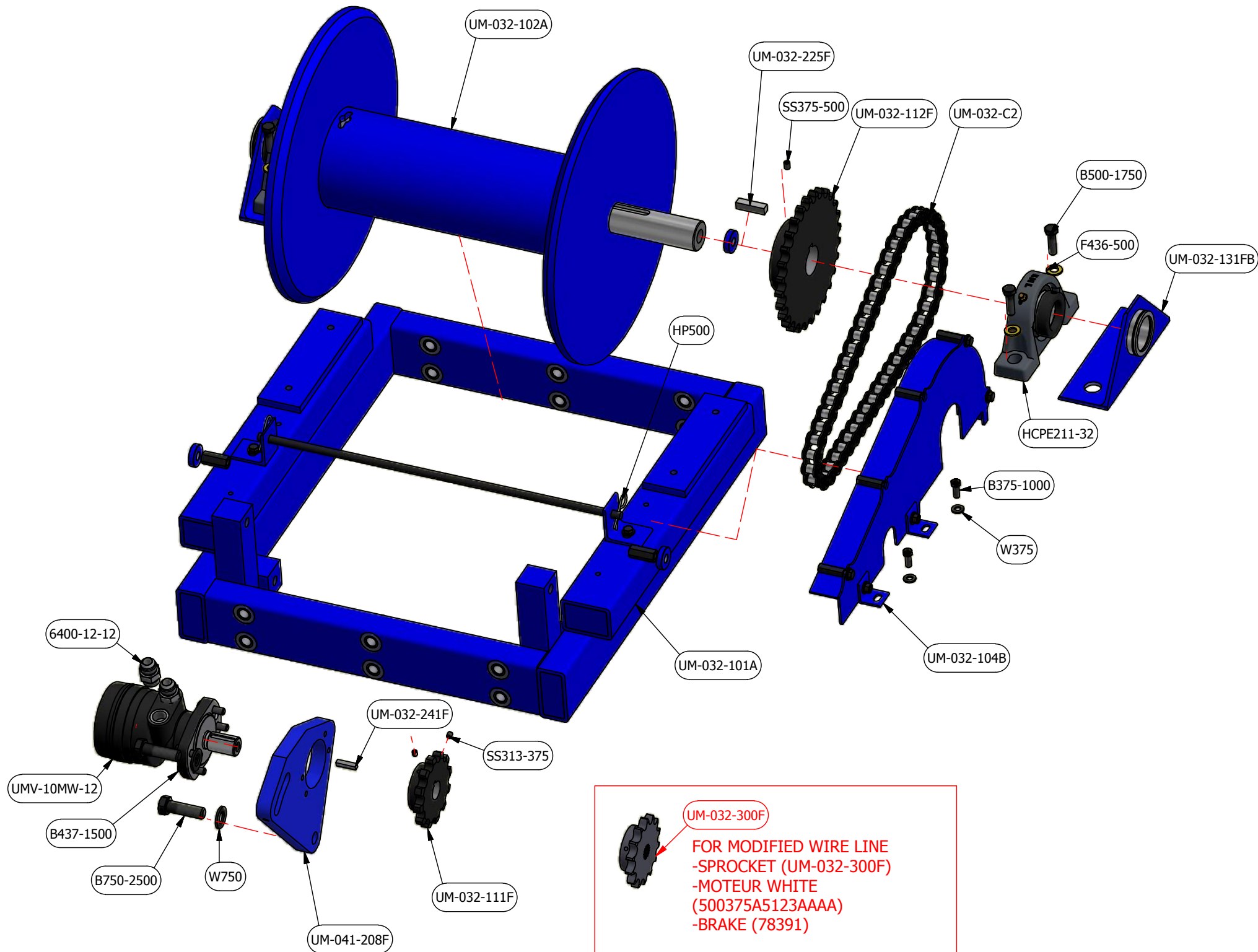

LISTE DE PIÈCE			
OLD NUMBER	ITEM	NOM/NAME	QTE
	6400-12-12	6400-12-12	4
	B375-1000	BOLT 3/8-UNC X 1"	2
	B437-1500	BOLT 7/16-UNC x 1 1/2"	8
	B500-1750	BOLT 1/2 - 13 NC X 1 3/4"	6
	B750-2500	BOLT 3/4-UNC x 2 1/2"	4
	F436-500	FLAT TENSION MECANIC WASHER 1/2"	4
	HCPE211-32	PILLOWS BLOCK HCPE211-32	2
131F	UM-032-101A	BASE FRAME	1
	UM-032-102A	DRUM ASSEMBLY W/O SPROCKET	2
	UM-032-104B	CHAIN GUARD 80 ASSEMBLY	2
	UM-032-111F	SPROCKET LEADING 80B12	2
	UM-032-112F	SPROCKET LEAD 80B28	2
133F	UM-032-131FB	TOP BACK SHIELD FRAME SWIVEL	2
	HP500	HAIRPIN SHAFT 1/2	2
	UM-032-225F	KEY 1/2 X 1/2 X 2 Lg	2
	UM-032-241F	KEY 5/16 in X 5/16 in X 1 3/8 Lg	2
	UM-032-C2	CHAIN 80 (50 Lg)	2
198F	UM-041-208F	HYDRAULIC MOTOR BRACKET	2
	UMV-10MW-12	MOTEUR WHITE RE12	2
	W375	FLAT WASHER 3/8	25
	W750	FLAT WASHER 3/4	4
	SS375-500	SET SCREW 3/8-16 UNC X 1/2"	2
	SS313-375	SET SCREW 5/16 X 3/8	2

DESIGNED BY:		CHECK BY:	
# DRAFT:	UM-032-C-8.4_REV3	DRAFT BY: G.Laroche	
# PROJECT:	UM-032	REV. 3	SCALE: N.T.S. DATE:
TITLE			
STEP 4			
PAGE: 8.4			

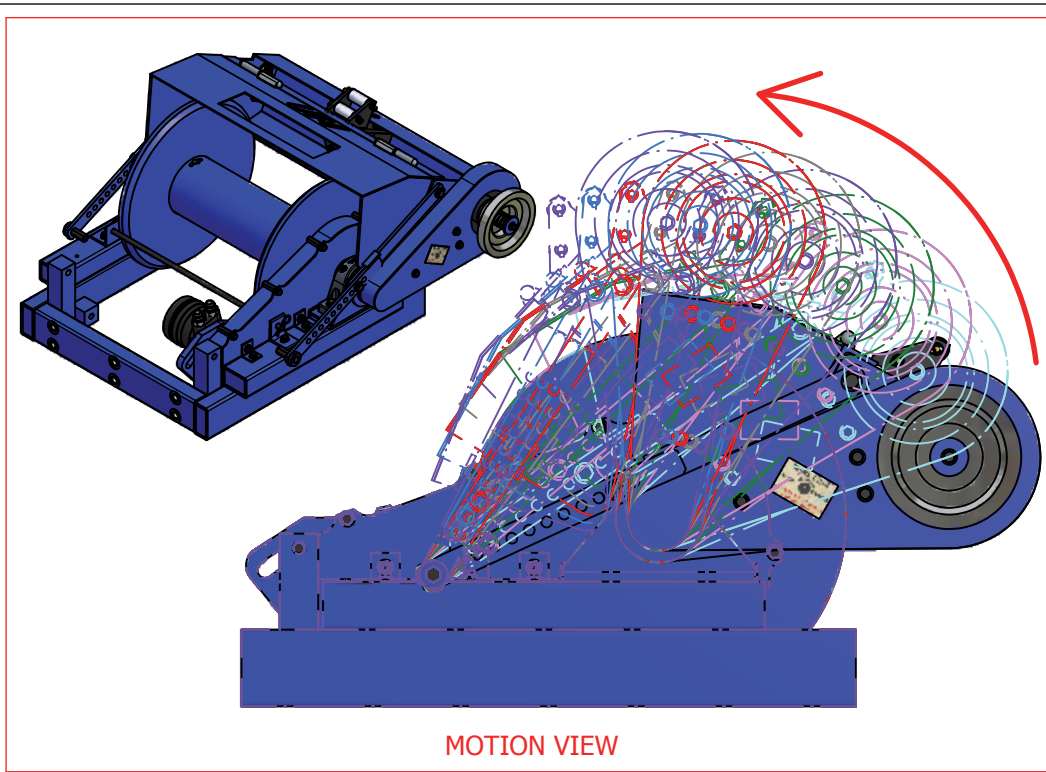

MOTION VIEW

POSITION AJUSTING HOIST FOR UP DRILLING			
ANGLE	HOLE OF ARMS	#ARMS 1	#ARMS 2
10°	#10	UM-032-116F	FIXED HOLE
20°	#9	UM-032-116F	FIXED HOLE
30°	#8	UM-032-116F	FIXED HOLE
40°	#7	UM-032-116F	FIXED HOLE

LISTE DE PIÈCE		
ITEM	NOM/NAME	QTE
UM-032-115F	LOWER ARM	2
UM-032-116F	UPPER ARM	2

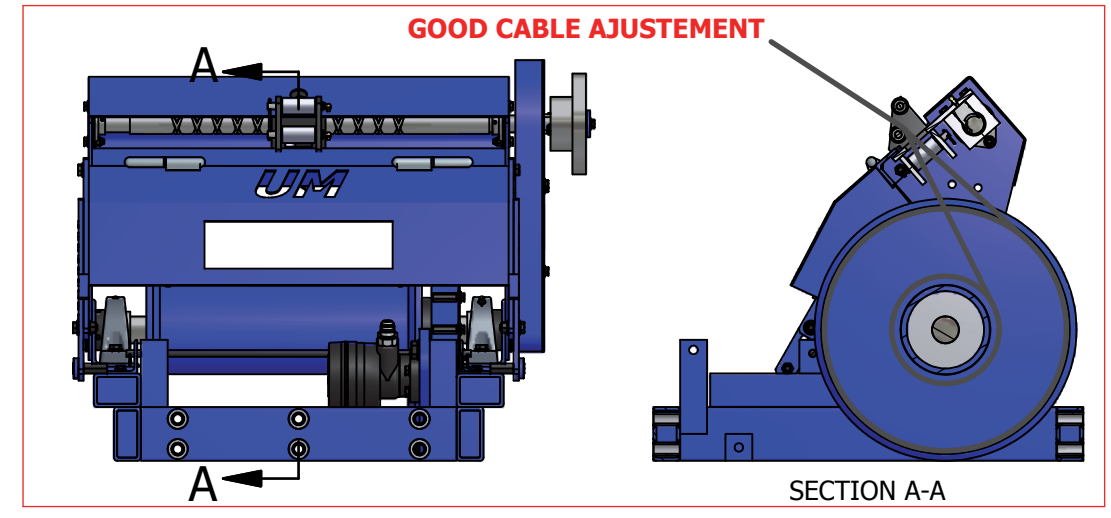

GOOD CABLE AJUSTEMENT

SECTION A-A

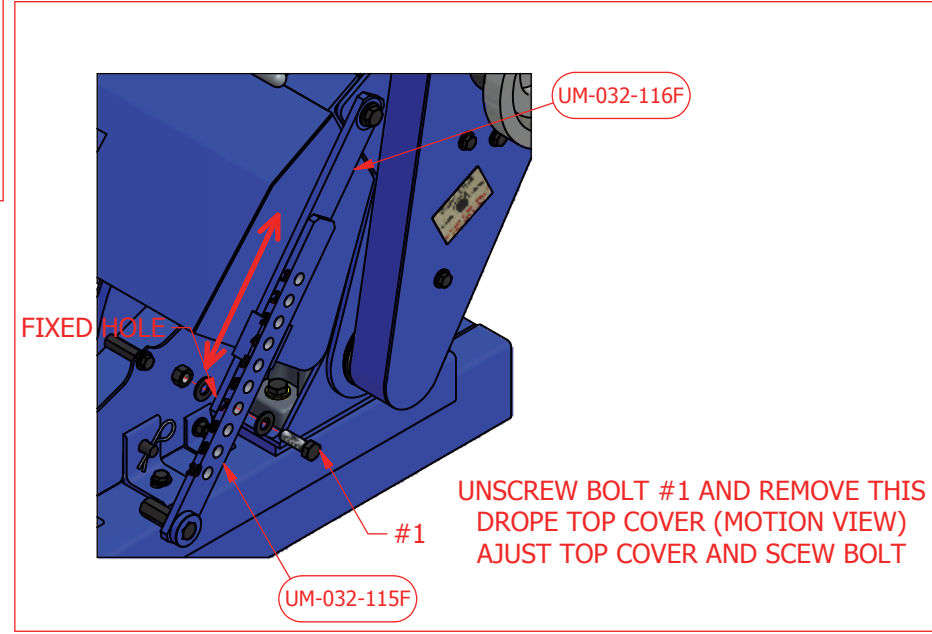

UNSCREW BOLT #1 AND REMOVE THIS DROPE TOP COVER (MOTION VIEW)
AJUST TOP COVER AND SCEW BOLT

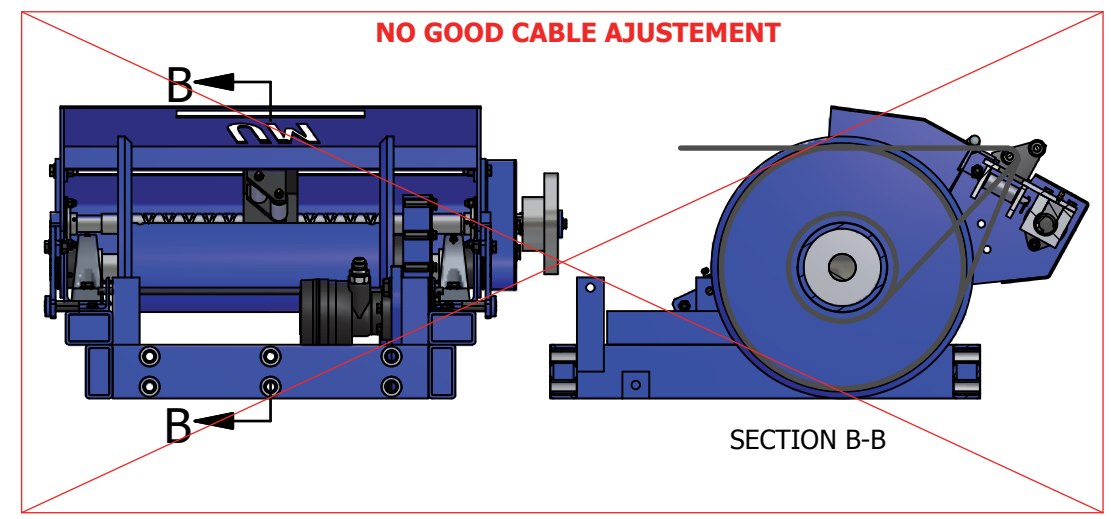

NO GOOD CABLE AJUSTEMENT

SECTION B-B

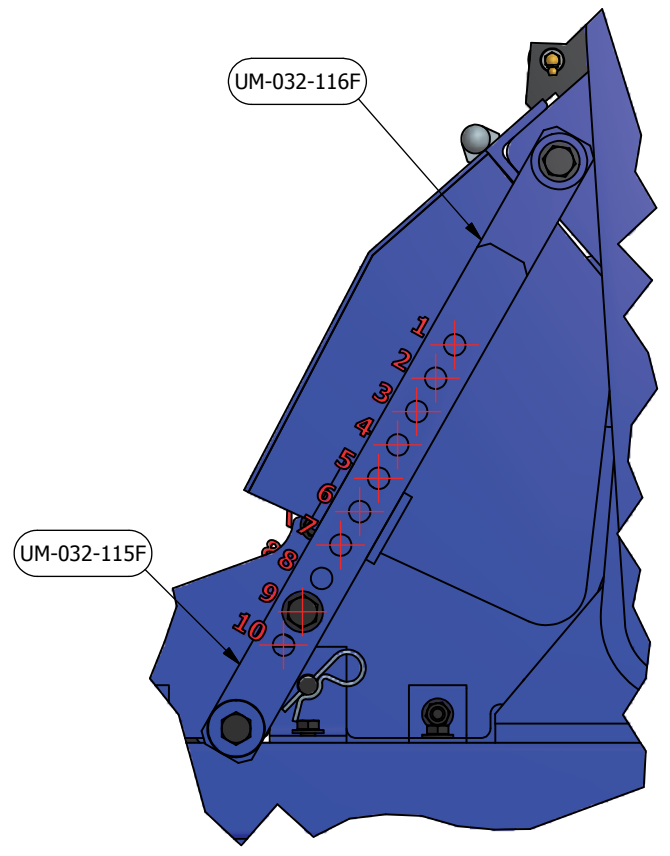

DETAIL B

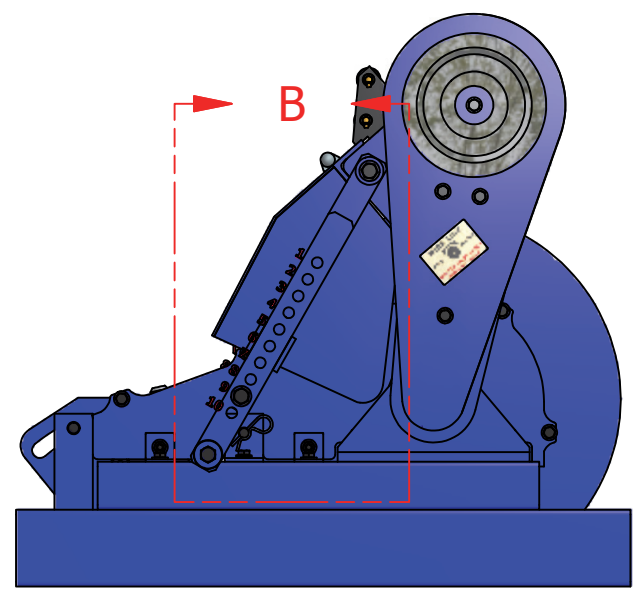

DESIGNED BY:	CHECK BY:	
# DRAFT:	DRAFT BY:	
# PROJECT:	REV. 0	SCALE: N.T.S. DATE:
TITLE		



POSITION AJUSTING HOIST FOR UP DRILLING			
ANGLE	HOLE OF ARMS	#ARMS 1	#ARMS 2
50°	9	UM-032-115F	N.A.
60°	8	UM-032-115F	N.A.
70°	7	UM-032-115F	N.A.

LISTE DE PIÈCE		
ITEM	NOM/NAME	QTE
UM-032-116F	UPPER ARM	2
UM-032-115F	LOWER ARM	2

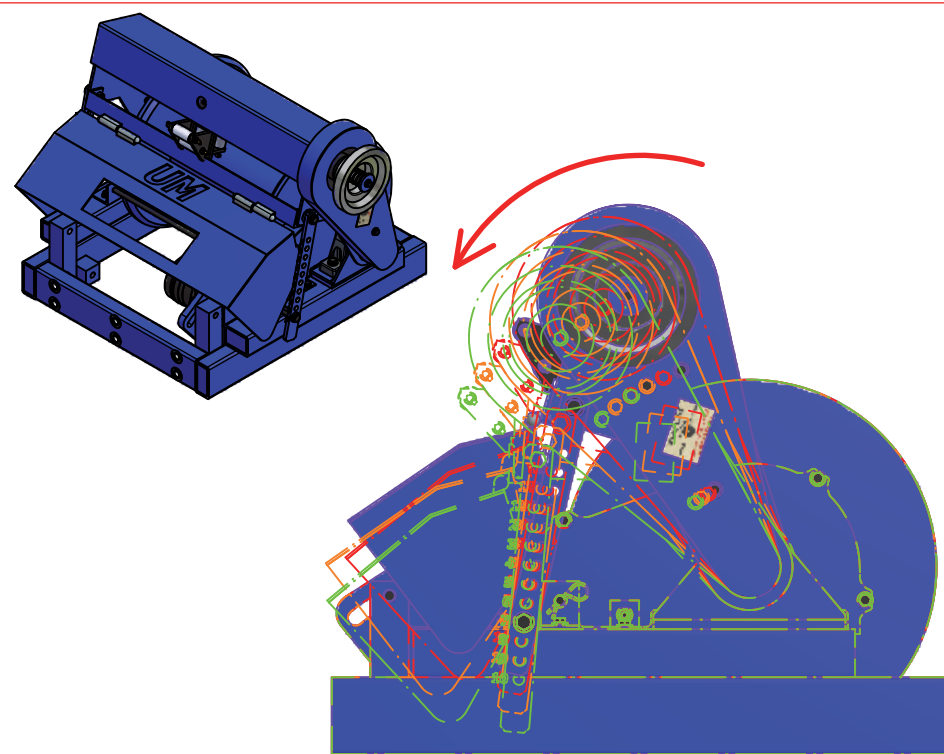

MOTION VIEWS

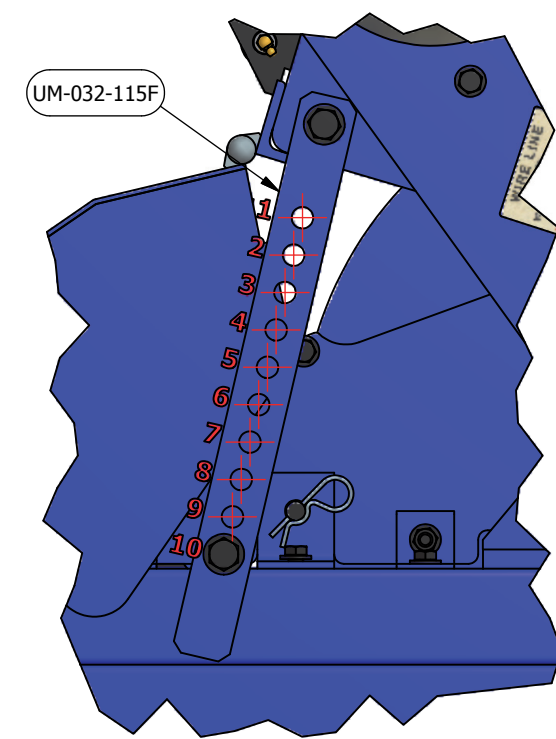
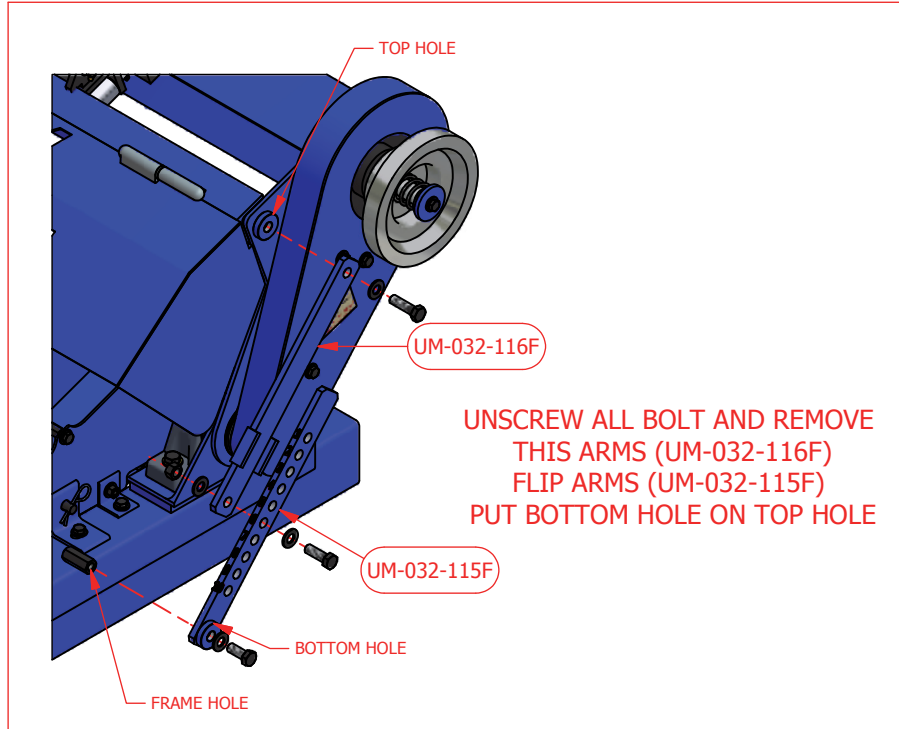
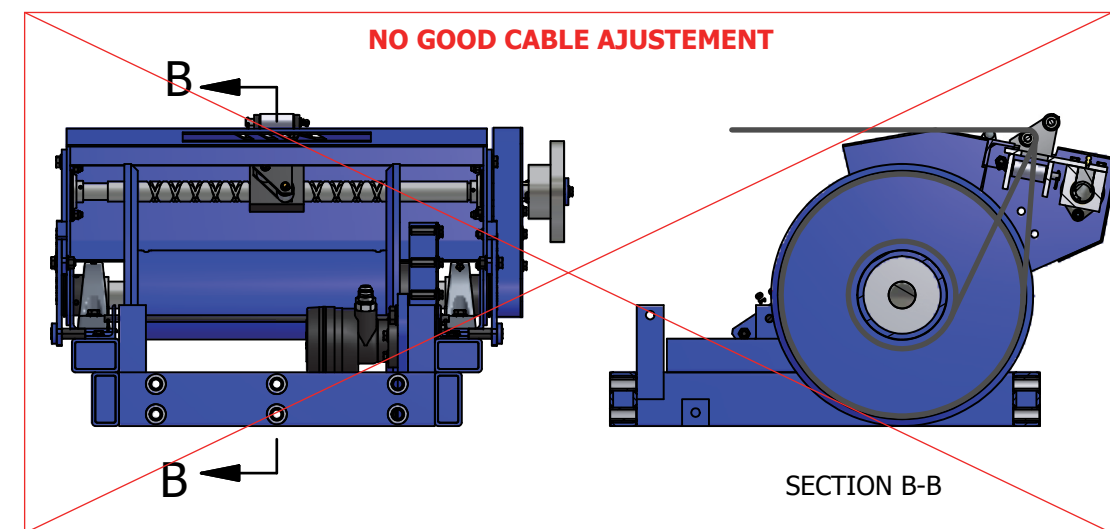
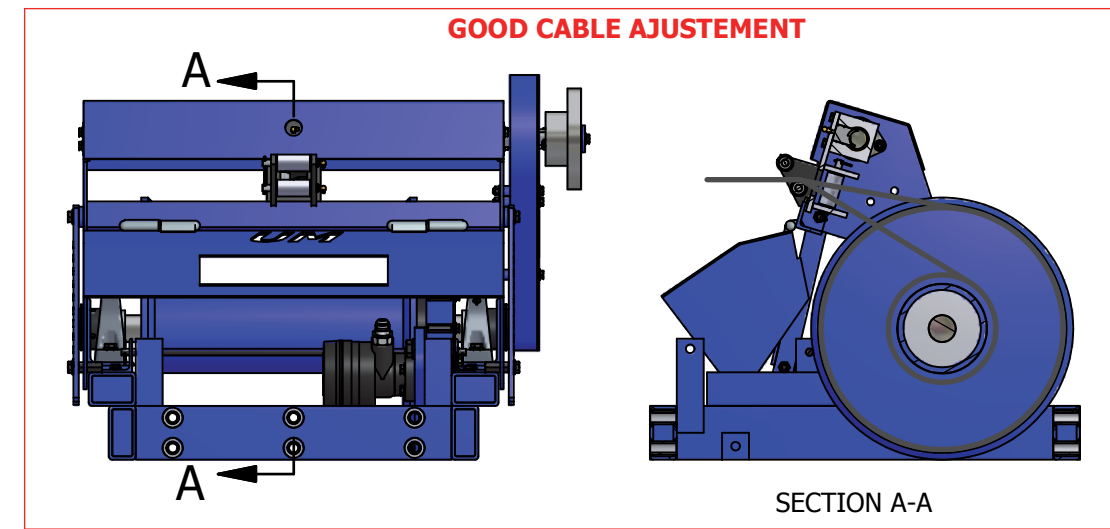

DETAIL B

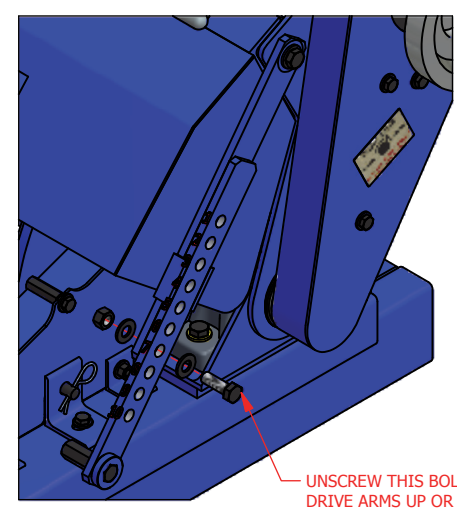
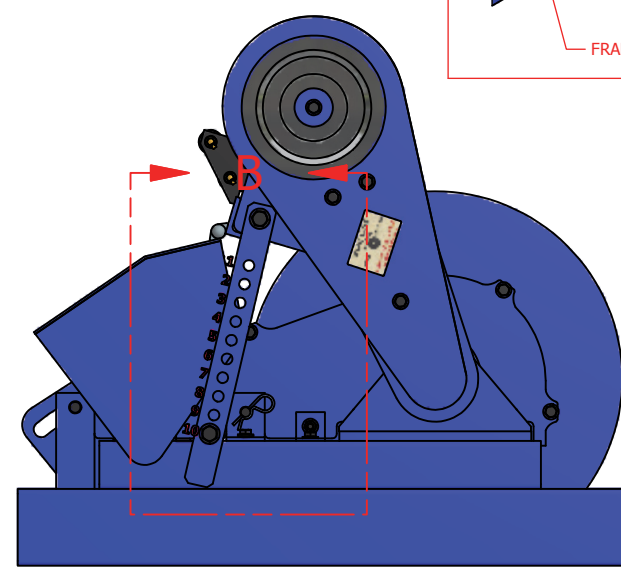

UNSCREW THIS BOLT FOR DRIVE ARMS UP OR DOWN HOLE

DESIGNED BY:	CHECK BY:	
# DRAFT:	DRAFT BY:	
# PROJECT:	REV. 0	SCALE: N.T.S. DATE:
TITLE		

180 Des distributeurs
 Val-d'Or, Québec
 Canada J9P-6Y1
 Tel : (819) 824-3977
 Fax : (819) 824-1077
 Email : info@amvcl.ca
 Web : www.amvcl.ca